

53 Tally Ho Drive Dundas, Ontario

Total Above Grade Exterior ft²
 Approx Above Ground Exterior Area = 1407.75 ft²

Total Exterior ft²
 Approx Exterior Area (basement included) = 2397.09 ft²
 Garage not included in total ft²

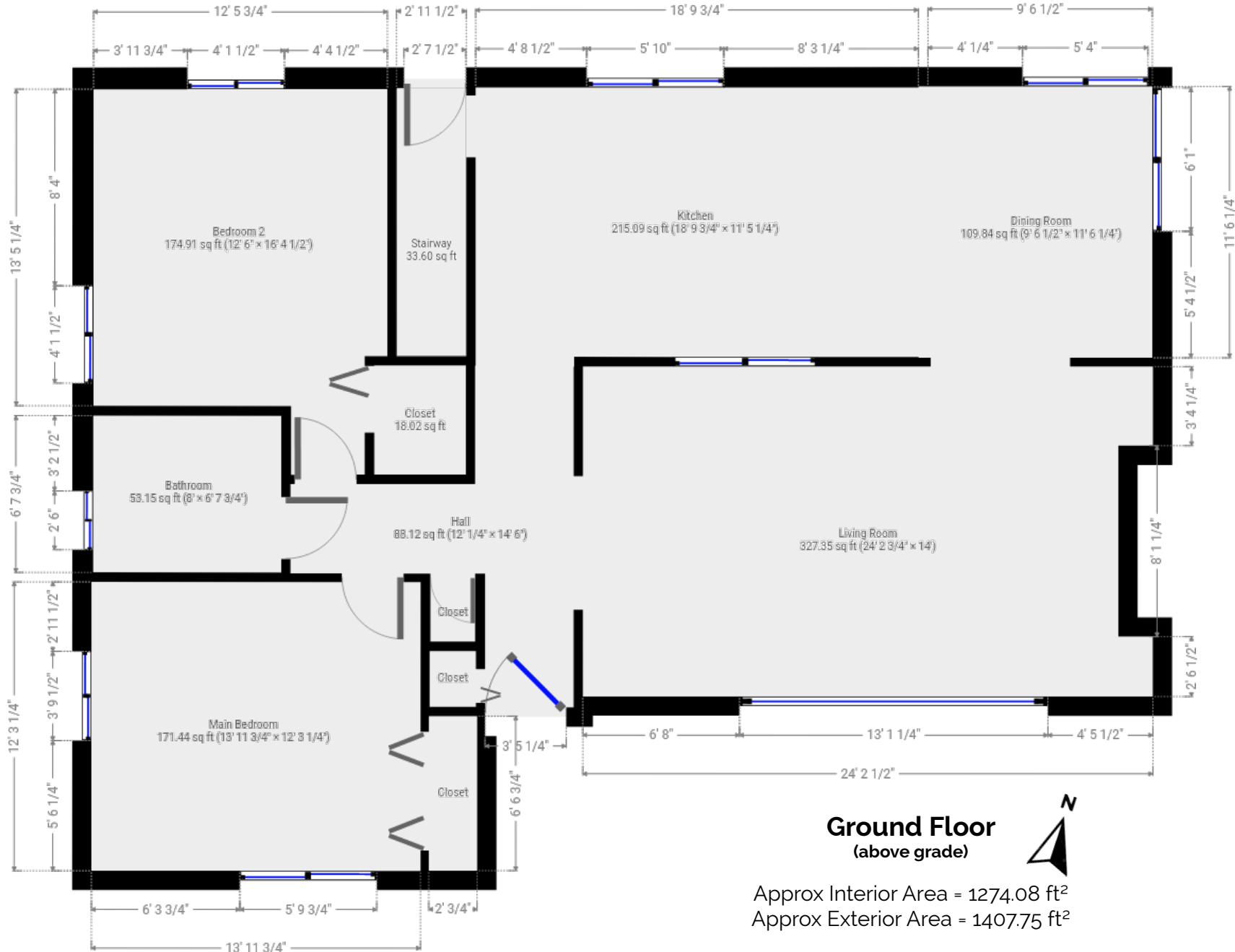

53 Tally Ho Drive Dundas, Ontario

Total Above Grade Exterior ft²
 Approx Above Ground Exterior Area = 1407.75 ft²

Total Exterior ft²
 Approx Exterior Area (basement included) = 2397.09 ft²
 Garage not included in total ft²

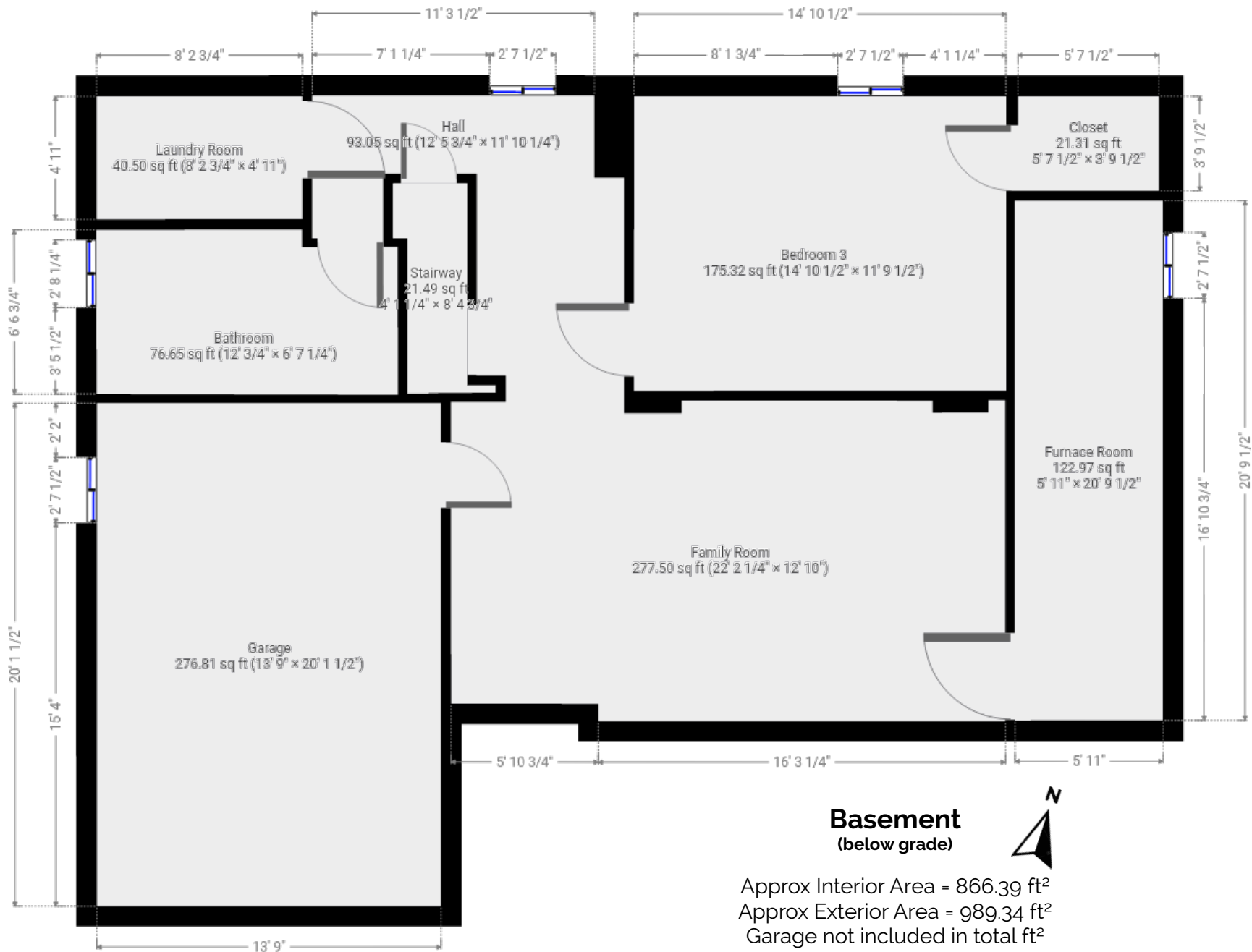

Main Room Interior Measurements

	Imperial	Metric	Interior ft ²
Ground Floor (above grade)			
Approx Exterior ft²			
1407.75 ft²			
Living Room	24'3 x 14'	7.39m x 4.27m	327.35 ft ²
Dining Room	9'7 x 11'6	2.92m x 3.51m	109.84 ft ²
Kitchen	18'10 x 11'5	5.74m x 3.48m	215.09 ft ²
Main Bedroom	8' x 6'8	2.44m x 2.03m	53.15 ft ²
Bedroom 2	12'6 x 16'5	3.81m x 5.00m	174.91 ft ²
Bathroom	8' x 6'8	2.44m x 2.03m	53.15 ft ²

Basement (below grade)

Approx Exterior ft²			
989.34 ft²			
Family Room	22'2 x 12'10	6.76m x 3.91m	277.50 ft ²
Bedroom 3	14'11 x 11'10	4.55m x 3.61m	175.32 ft ²
Furnace/Storage	5'11 x 20'10	1.80m x 6.35m	122.97 ft ²
Bathroom	12'1 x 6'7	3.68m x 2.01m	76.65 ft ²
Laundry Room	8'3 x 4'11	2.51m x 1.50m	40.50 ft ²
Garage *	13'9 x 20'2	4.19m x 6.15m	276.81 ft ²

Totals

Total Above Grade Exterior ft²
Approx Above Ground Exterior Area = 1407.75 ft²

Total Exterior ft²
Approx Exterior Area (basement included) = 2397.09 ft²
Garage not included in total ft²

Rooms have irregular shapes and, as such, cannot be truly represented by one length and width. The length and width listed above are the longest length and width of the room. Because of this, room area is not always equal to the product of length and width but has been calculated in any floor area accurately using all wall measurements.

